

## Saf-T Wing® Blood Collection Set

### Clinical Tips for Success

#### ISSUE

Difficult to use “one-handed” technique

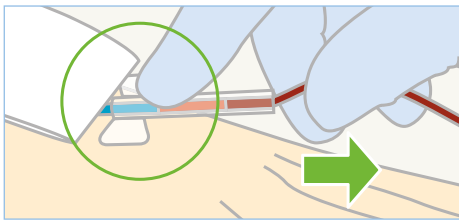

#### POSSIBLE CAUSES

- Placing fingers too far back on tubing to activate the safety device.
- Arterial vascular access procedures.

#### TIP FOR SUCCESS

- Place the index finger of your dominate hand on the finger stop. Grasp the tubing as close to the wing housing as possible with your thumb and middle finger. Gently and quickly, pull back the tubing to activate the safety mechanism.
- Arterial vascular procedures are an off-label use.

#### ISSUE

Difficult to activate safety and hear/feel “CLICK”

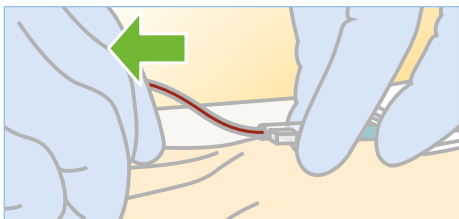

#### POSSIBLE CAUSES

- Holding wing body too tightly may result in restricting the activation of the safety mechanism.
- Grabbing tubing to activate the safety mechanism too far back from the wing body.
- Pulling tubing slowly.

Do NOT Squeeze.



#### TIP FOR SUCCESS

- Using the “two handed” technique: keeping hands behind the needle, stabilize Saf-T Wing® set by placing the thumb and index finger of your nondominant hand on the patient on either side of the wing body. Stabilize without squeezing the wing body.
- Grasp the tubing as close to the wing housing as possible with your thumb and index finger. Gently and quickly, pull back the tubing to activate the safety mechanism.

#### ISSUE

Blood released/sprays out from tip of needle



#### POSSIBLE CAUSES

- Activation outside of the vein.

#### TIP FOR SUCCESS

- This product has been designed for in-vein activation.
- Place gauze over the venipuncture site prior to activation of the safety mechanism. Do not apply digital pressure until the safety feature has been activated (Pull-Click-Press).
- Use the side clamp after activating the safety mechanism.

#### ISSUE

Tubing collapses

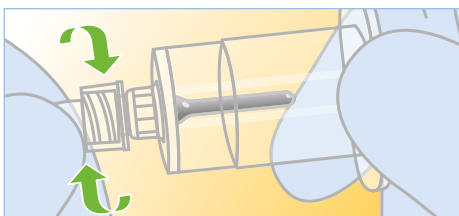

#### POSSIBLE CAUSES

Too much negative pressure:

- Vein too small and unable to refill.
- Vacuum tube creating too much pressure.
- Syringe too large.
- The tubing is not securely connected to the syringe or vacuum tube holder.

#### TIP FOR SUCCESS

- With a vacuum draw, switch to a syringe.
- With syringe draw: break the seal of the plunger, moving it within the barrel of the syringe. Expel all air by advancing the plunger fully forward.
- Ensure that the tubing is securely connected to the syringe or the vacuum tube holder.

MKEECA-0120

PRODUCT(S) DESCRIBED MAY NOT BE LICENSED OR AVAILABLE FOR SALE IN CANADA AND OTHER COUNTRIES

**EC Authorized Representative**  
Smiths Medical International Ltd.  
TN25 4BF, UK  
Phone: +44 (0) 1233 722100

**Smiths Medical International**  
1500 Eureka Park, Lower Pemberton  
Ashford Kent, TN25 4BF  
Phone: +44 (0)845 850 0445  
[www.smiths-medical.com](http://www.smiths-medical.com)

**Rx**  
**ONLY**

**smiths medical**

Find your local contact information at: [www.smiths-medical.com/customer-support/contact-us](http://www.smiths-medical.com/customer-support/contact-us)

Smiths Medical is part of the global technology business Smiths Group plc. Please see the Instructions for Use/Operator's Manual for a complete listing of the indications, contraindications, warnings and precautions. Saf-T Wing, Jelco and the Smiths Medical design mark are trademarks of Smiths Medical. The symbol ® indicates the trademark is registered in the U.S. Patent and Trademark Office and certain other countries. Product referenced is CE-marked. ©2017 Smiths Medical. All rights reserved. SS195447GB-082017